

The image shows the interior of a wooden sauna. The walls and ceiling are clad in light-colored wood panels. In the foreground, there are several wooden benches. A small, arched window with a hanging light fixture is visible in the background. The overall atmosphere is warm and cozy.

S a u n a

m a h o g a n y / s a m b a

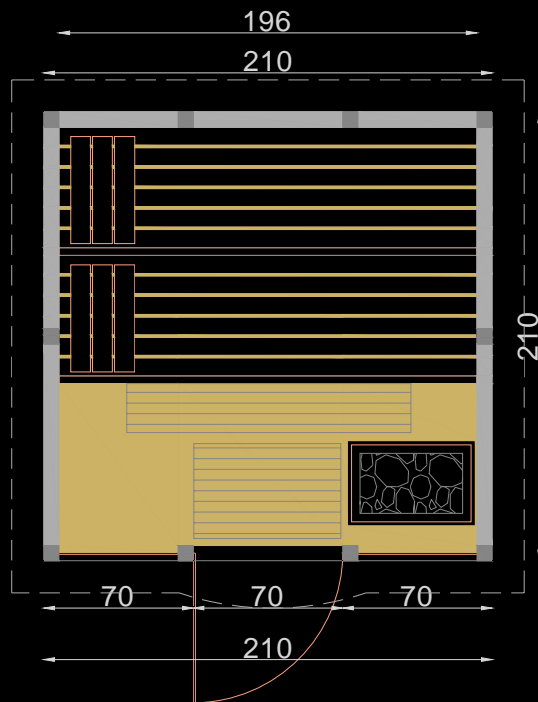

This luxury and very bright square sauna is manufactured from A class mahogany panelings, profile STP, d= 15mm.

Sauna ceiling is manufactured from A class samba panelings , profile STP , d= 15mm.

Sauna is delivered in sandwich elements / easy to assemble /.

All benches are manufactured from massive samba wood in A class. Finishing is soft line.

Back rests and benches skirts are also made from A class samba wood. Head supports and stove guard are also made from A class samba wood.

Duck board is made from A class teak wood.

This sauna like all other our models you can easy assemble according to our manual instruction "do it your self".

Sauna is equipped with outdoor halogen spot lights which are built in mahogany crown surrounding three sides of sauna.

All windows and doors are made from 8 mm tempered secured colored glasses.

red alder



samba



aspen



mahagoni





Optional

- starlight sky , fiber optic light 16 stars
- light therapy , 4 colours,blue,green, red and yellow color
- sauna speakers waterproof, resistant up to 120°C



Door handle is made from same massive wood from which is manufactured sauna cabin. Door locker is with magnet latch.

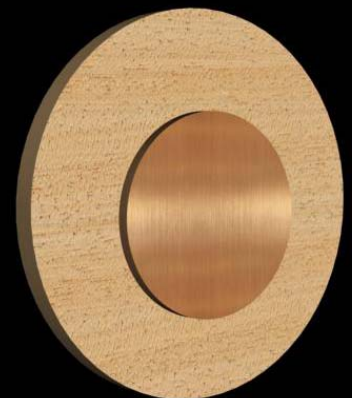

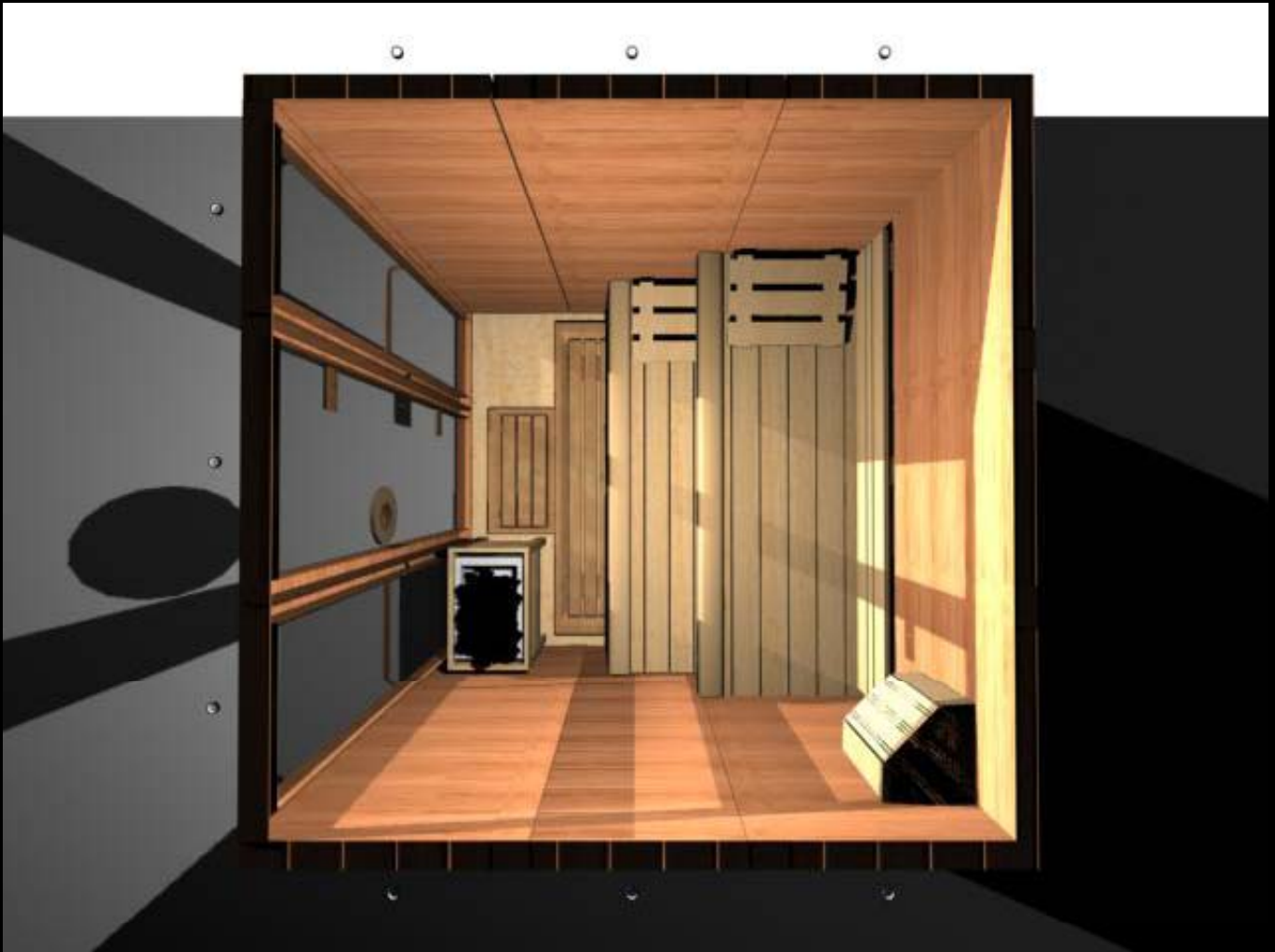

All saunas are equipped with A class teak wood duck board. Wood finishing is with teak oil





Difference from other sauna manufacturers is that we are manufacturing benches from massive samba wood.

